

# Architectural Glass Hardware



HECKLER® | GLASS HARDWARE  
SOLUTIONS

# CONTENTS

Foreword	04
Floor Springs	06
Patch Fittings	09
Handles	13
Shower Fittings	18
Sliding System	31
Spider Fittings	33
Door Closers	38



## Foreword

Technology is an integral part of our lives today. A part that is constantly evolving as new innovations come in and change our lives for the better. We always seek the new – availing the benefits of technology to add more convenience, more security, more comfort to our lives.

At Heckler glass hardware, we keep a finger on the pulse of our customers. Inspired by their needs, we seek to blend innovation and technology, to offer solutions that perfectly match their needs. This has been our philosophy for the past 26 years, during which we've built a bond of trust, as well as a reputation for quality, technology and aesthetics, with our customers.

We import advanced equipment from Germany as well as the advanced techniques. Our technique reaches the top of 21 century's. We keep inaugurating and perfecting our products to make them easier to use. Its safety, economy and high quality won broad trusts and compliments from the users.

Going forward, we will continue to innovate premium, comprehensive hardware solutions. For us, perfection will always lie in the details, and our solutions will remain extremely secure and robust, easy to install and operate, and flexible to meet the challenges of diverse applications.

With our architectural hardware range, we aim to strengthen our reputation of being an organisation dedicated to blending innovation and technology – and creating a better, safer future.

**Heckler hardware**



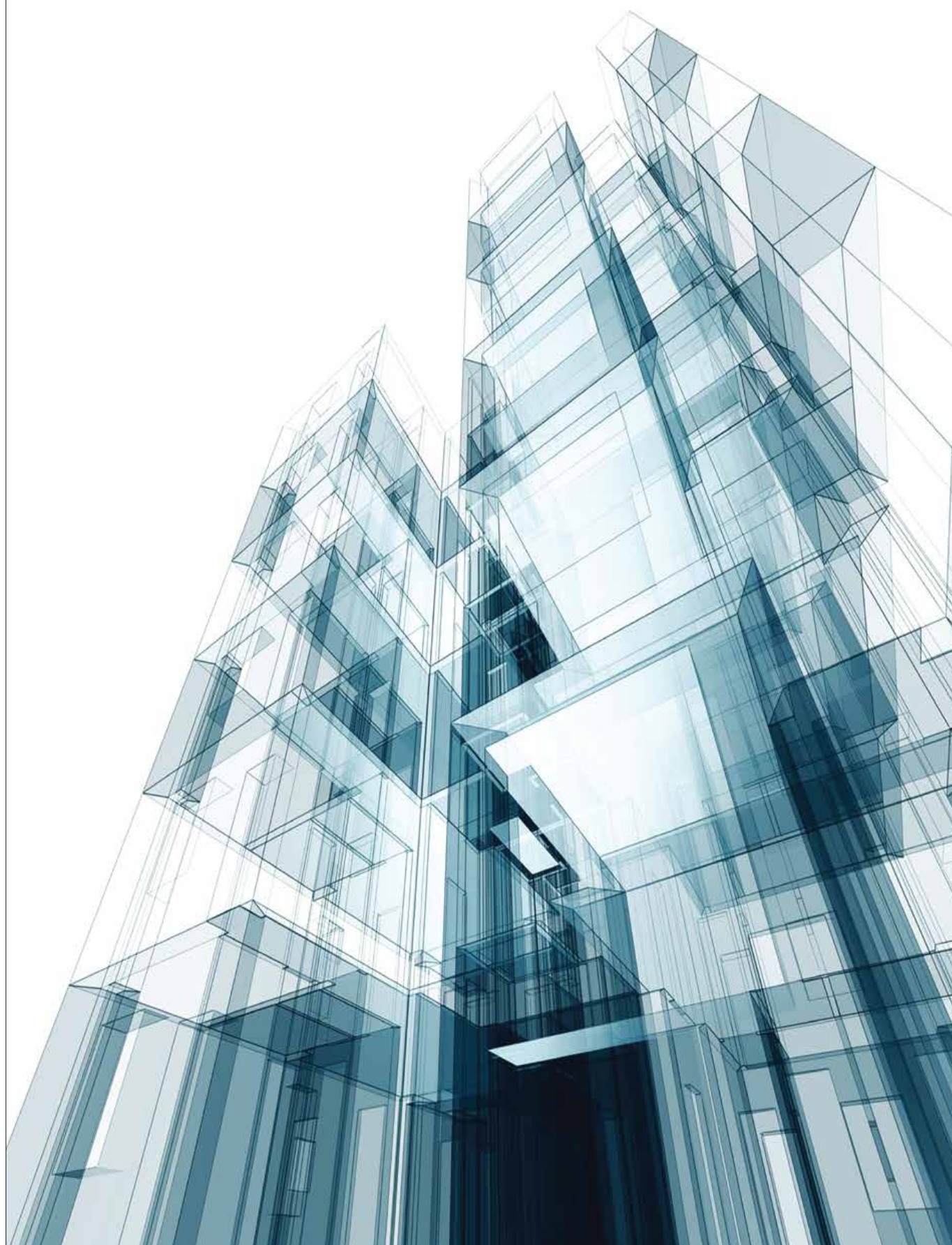



- ● Floor Springs

## FC05 - Floor Spring

Product code **FC05**



Maximum door weight	<b>100 kg</b>
Maximum door width	<b>1000 mm</b>
Product dimensions (LxWxH)	<b>310x108x40</b>
Max open degree	<b>116°</b>
Hold open	<b>90°</b>
Closing speed	<b>90° - 15°</b>
Latching speed	<b>15° - 0°</b>
Applicable temperature	<b>-20°C - 45°C</b>
Passed durability test (cycles)	<b>&gt;1000,000</b>

### Features

- Pass the test of EN1154 door closing detection
- Pass the test of industrial standard QB/T 2697
- Pass the test of SGS & PONY
- Thermostable hydraulic fluid to ensure smooth operation in any climatic condition
- Passed one million times durability test
- Applicability temperature from -20°C to 45°C
- SS 304 Coverplate for high corrosion resistance
- Suit for wooden door, glass door, metal door, frame door



## FC06 - Floor Spring

Product code **FC06**



Maximum door weight	<b>120 kg</b>
Maximum door width	<b>1200 mm</b>
Product dimensions (LxWxH)	<b>310x108x40</b>
Max open degree	<b>116°</b>
Hold open	<b>90°</b>
Closing speed	<b>90° - 15°</b>
Latching speed	<b>15° - 0°</b>
Applicable temperature	<b>-20°C - 45°C</b>
Passed durability test (cycles)	<b>&gt;1000,000</b>

### Features

- Pass the test of EN1154 door closing detection
- Pass the test of industrial standard QB/T 2697
- Pass the test of SGS & PONY
- Thermostable hydraulic fluid to ensure smooth operation in any climatic condition
- Passed one million times durability test
- Applicability temperature from -20°C to 45°C
- SS 304 Coverplate for high corrosion resistance
- Suit for wooden door, glass door, metal door, frame door



**FC09 - Super Heavy Duty Floor Spring**Product code **FC09**

Maximum door weight	<b>180 kg</b>
Maximum door width	<b>1500 mm</b>
Product dimensions (LxWxH)	<b>310x108x40</b>
Max open degree	<b>116°</b>
Hold open	<b>90°</b>
Closing speed	<b>90° - 15°</b>
Latching speed	<b>15° - 0°</b>
Applicable temperature	<b>-20°C - 45°C</b>
Passed durability test (cycles)	<b>&gt;1000,000</b>

**Features**

- Pass the test of EN1154 door closing detection
- Pass the test of industrial standard QB/T 2697
- Pass the test of SGS & PONY
- Thermostable hydraulic fluid to ensure smooth operation in any climatic condition
- Passed one million times durability test
- Applicability temperature from -20°C to 45°C
- SS 304 Coverplate for high corrosion resistance
- Suit for wooden door, glass door, metal door, frame door





- Patch Fittings



**HL01 - Bottom Patch**Product code **HL01****Features**

- SS 304 cover for high corrosion resistance
- Spring loaded push pins for easy installation and for firm fitting
- Universal pivot hole dimensions for easy fitment with floor springs
- Gaskets provided to accommodate glass from 10-12 mm thickness and avoid glass damage

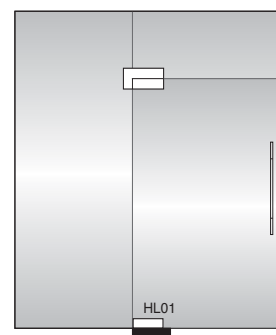
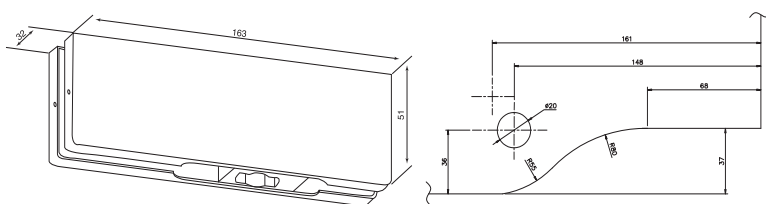
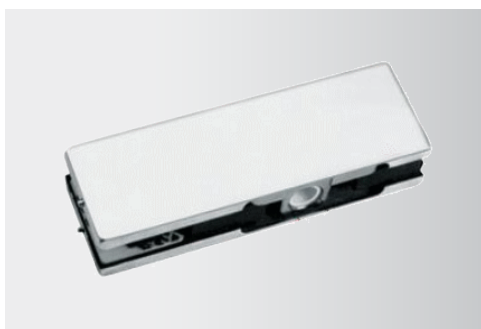
**HL02 - Top Patch**Product code **HL02****Features**

- SS 304 cover for high corrosion resistance
- Spring loaded push pins for easy installation and for firm fitting
- Needle bearing in the pivot point for consistent, long lasting and smooth motion
- Pivot hole diameter of 15 mm
- Gaskets provided to accommodate glass from 10-12 mm thickness and avoid glass damage

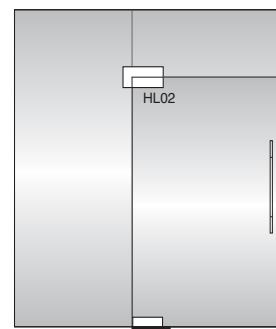
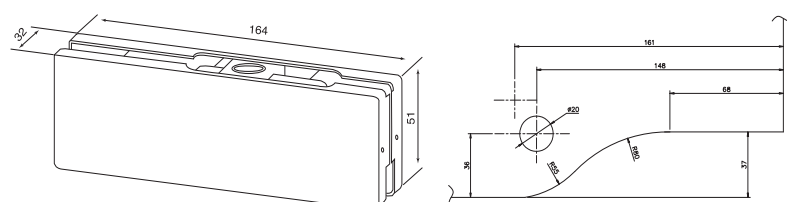

### HL03 - Over Panel Patch with Pivot

Product code **HL03**



#### Features

- SS 304 cover for high corrosion resistance
- Spring loaded push pins for easy installation and for firm fitting
- Pivot diameter of 15 mm
- Gaskets provided to accommodate glass from 10-12 mm thickness and avoid glass damage

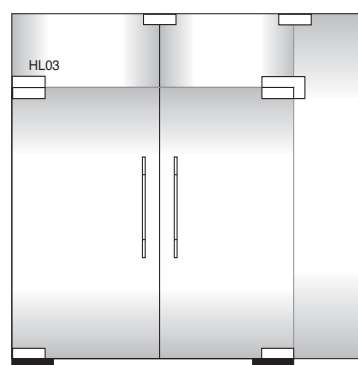
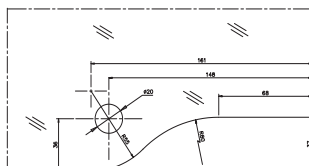
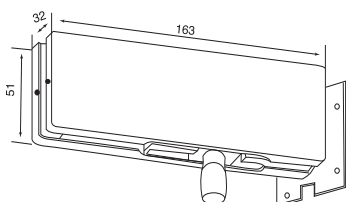

### HL04 - L-Arm Patch with Pivot

Product code **HL04**



#### Features

- SS 304 cover for high corrosion resistance
- Spring loaded push pins for easy installation and for firm fitting
- Pivot diameter of 15 mm
- Gaskets provided to accommodate glass from 10-12 mm thickness and avoid glass damage

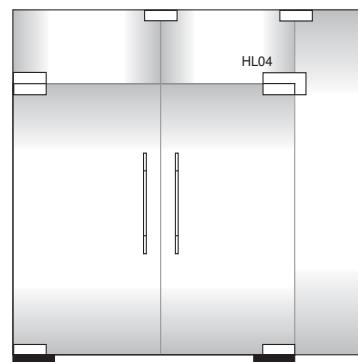
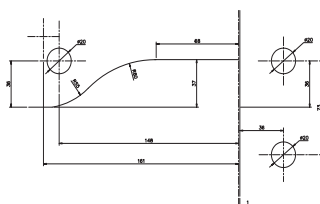
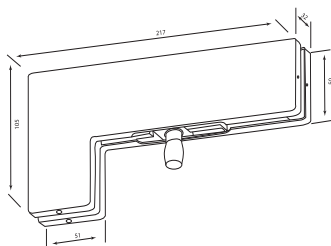



### HL05 - Bottom Lock Patch

Product code **HL05**



#### Features

- SS 304 cover for high corrosion resistance
- Spring loaded push pins for easy installation and for firm fitting
- Gaskets provided to accommodate glass from 10-12 mm thickness and avoid glass damage

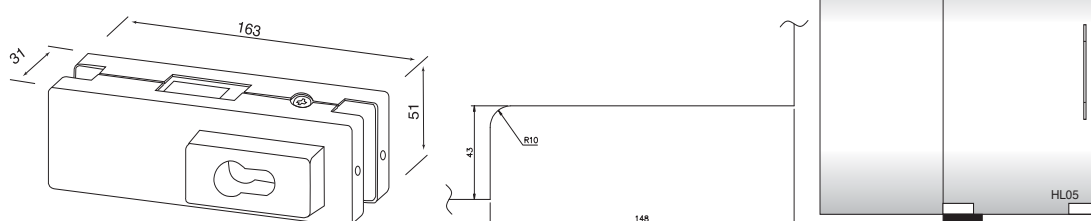

### HL08 - Pivot Plate

Product code **HL08**



#### Features

- SS 304 Pivot Plate for durability and high corrosion resistance

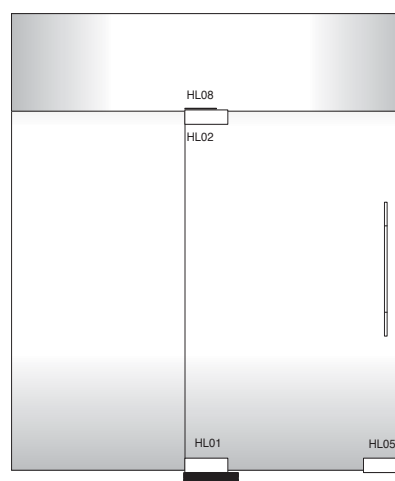
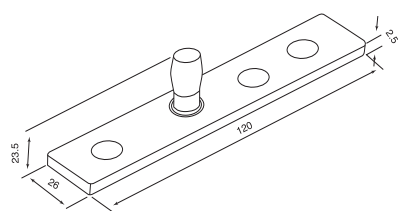



- • Handles

### HL11 - Pull Handle

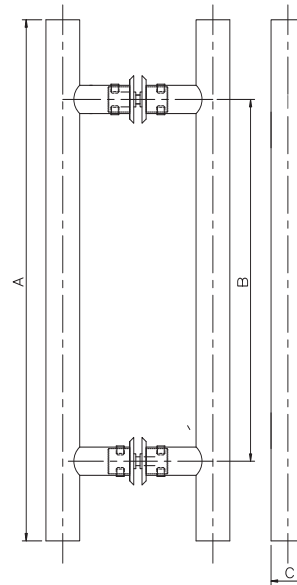

PRODUCT CODE	A (mm)	B (mm)	C (mm)
HL11-06	600	400	32
HL11-08	800	600	32
HL11-10	1000	800	32
HL11-12	1200	1000	32
HL11-15	1500	1100	38

#### Features

- Made of SS 304 material for high corrosion resistance
- Sleek design for firm grip

### HL20 - Pull Handle

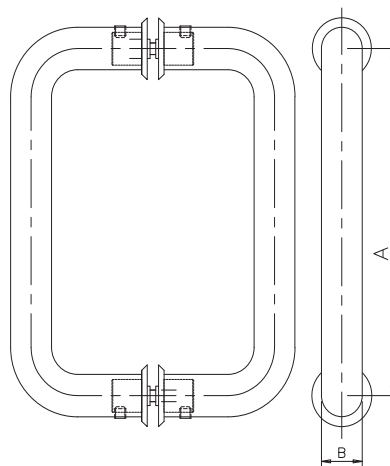

PRODUCT CODE	A (mm)	B (mm)
HL20-03	300	25

#### Features

- Made of SS 304 material for high corrosion resistance
- Sleek design for firm grip
- Polish finish

## HL22 - Pull Handle



PRODUCT CODE	A (mm)	B (mm)
HL22-03	300	15x30
HL22-05	500	15x30

### Features

- Sleek designer handle
- Made of SS 304 material for high corrosion resistance
- Polish finish



## HL16 - Shower Cubicle Handle

PRODUCT CODE	A (mm)	B (mm)	C (mm)
HL16-235	235	435	25
HL16-275	275	475	25

### Features

- Shower Door Handle with towel handle
- Made of SS 304 which offers high corrosion resistance
- Polish finish

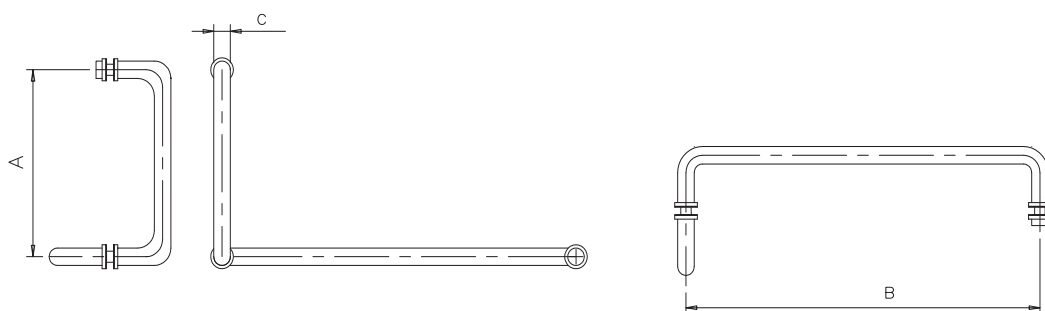



### HL23 - Shower Cubicle Handle

PRODUCT CODE	A (mm)	B (mm)	C (mm)
HL23-235	235	435	25x30
HL23-275	275	475	25x30

#### Features

- Shower door handle with towel handle
- Towelbar outside and handle inside
- Made of SS 304 which offers high corrosion resistance
- Polish finish



### HL31 - Shower Cubicle Handle

#### Features

- Knob inside and outside
- Made of SS 304 which offers high corrosion resistance
- Polish finish





- • Shower Fittings





### HL40 - Wall to Glass Hinge

Product code **HL40**

#### Features

- Developed for firm holding of glass door to the wall
- Made of SS 304 which makes the fittings highly corrosion resistant
- Gaskets provided to accommodate glass from 8-12 mm
- Suitable for door weight up to 50 kg
- The door will shut automatically when closed till 25 degrees

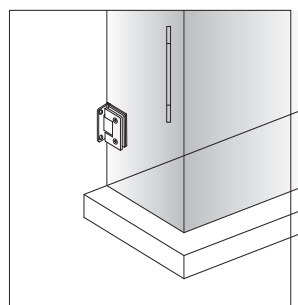
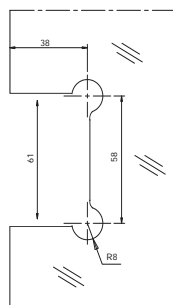
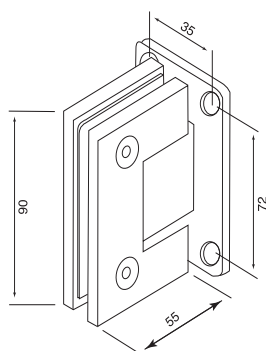

### HL41 - Wall to Glass Hinge

Product code **HL41**

#### Features

- Developed for firm holding of glass door to the wall
- Made of SS 304 which makes the fittings highly corrosion resistant
- Gaskets provided to accommodate glass from 8-12 mm
- Suitable for door weight up to 50 kg
- The door will shut automatically when closed till 25 degrees

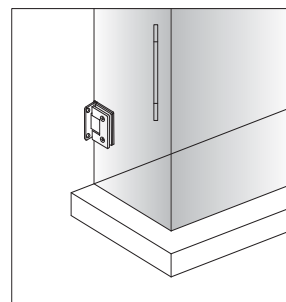
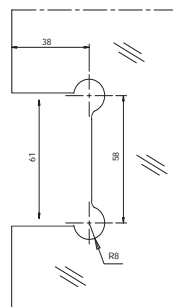
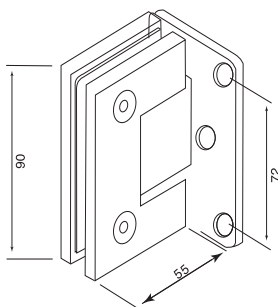



### HL42 - Glass to Glass Hinge 135 Degrees

Product code **HL42**

#### Features

- Developed for firm connecting of glass door with fixed glass at 135 degrees
- Made of SS 304 which makes the fittings highly corrosion resistant
- Gaskets provided to accommodate glass from 8-12 mm thickness and avoid glass damage
- Suitable for door weight up to 50 kg
- The door will shut automatically when closed till 25 degrees

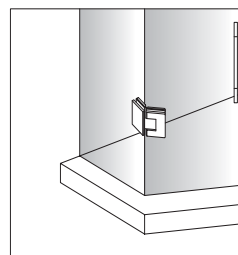
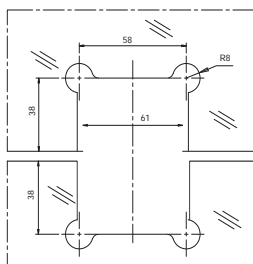
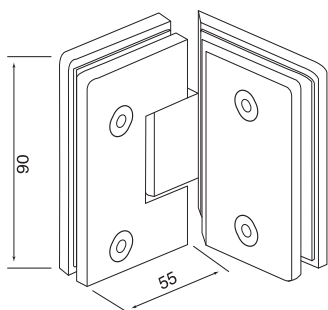

### HL43 - Glass to Glass Hinge 180 Degrees

Product code **HL43**

#### Features

- Developed for firm connecting of glass door with fixed glass at 180 degrees
- Made of SS 304 which makes the fittings highly corrosion resistant
- Gaskets provided to accommodate glass from 8-12 mm thickness and avoid glass damage
- Suitable for door weight up to 50 kg
- The door will shut automatically when closed till 25 degrees

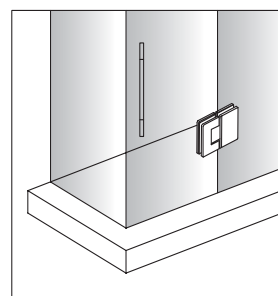
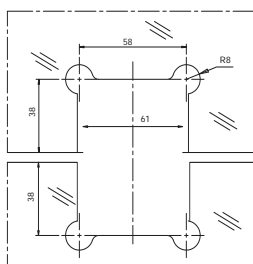
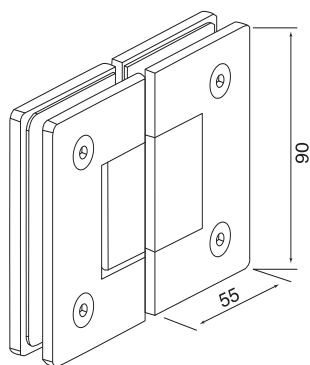



## HL44 Glass to Glass Hinge 90 Degrees

Product code **HL44**

### Features

- Developed for firm connecting of glass door with fixed glass at 90 degrees
- Made of SS 304 which makes the fittings highly corrosion resistant
- Gaskets provided to accommodate glass from 8-12 mm thickness and avoid glass damage
- Suitable for door weight up to 50 kg
- The door will shut automatically when closed till 25 degrees

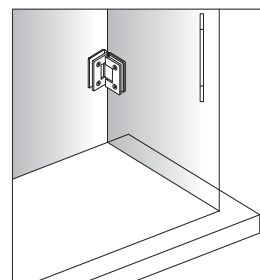
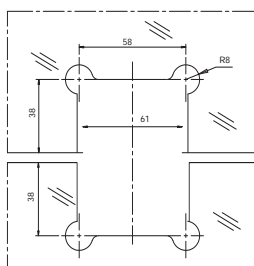
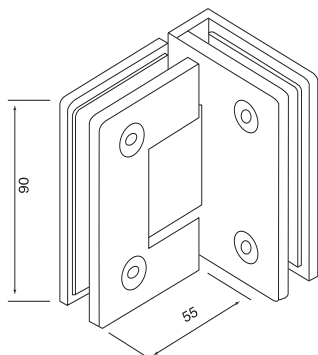

## HL60 - Wall to Glass Hinge

Product code **HL60**

### Features

- Developed for firm holding of glass door to the wall
- Made of SS 304 which makes the fittings highly corrosion resistant
- Gaskets provided to accommodate glass from 8-12 mm
- Suitable for door weight up to 50 kg
- The door will shut automatically when closed till 25 degrees
- Can be used for two-way operation of door

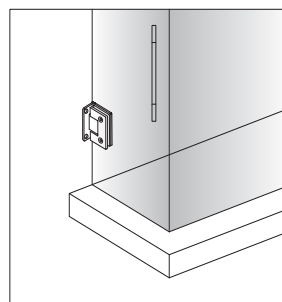
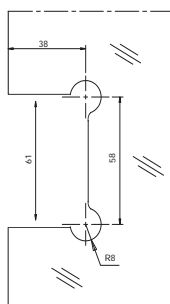
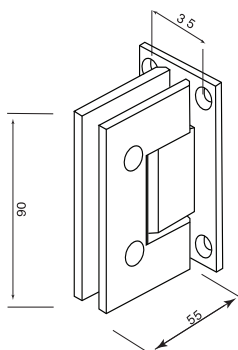



### HL61 - Wall to Glass Hinge

Product code **HL61**

#### Features

- Developed for firm holding of glass door to the wall
- Made of SS 304 which makes the fittings highly corrosion resistant
- Gaskets provided to accommodate glass from 8-12 mm
- Suitable for door weight up to 50 kg
- The door will shut automatically when closed till 25 degrees

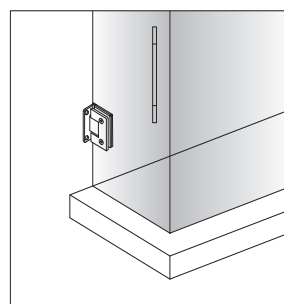
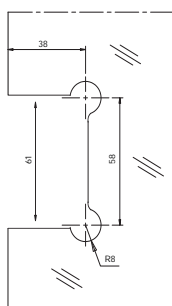
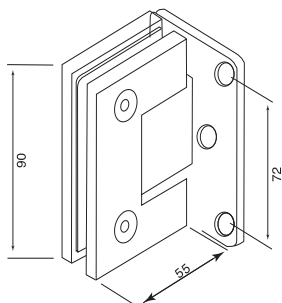

### HL62 - Glass to Glass Hinge 135 Degrees

Product code **HL62**

#### Features

- Developed for firm connecting of glass door with fixed glass at 135 degrees
- Made of SS 304 which makes the fittings highly corrosion resistant
- Gaskets provided to accommodate glass from 8-12 mm thickness and avoid glass damage
- Suitable for door weight up to 50 kg
- The door will shut automatically when closed till 25 degrees

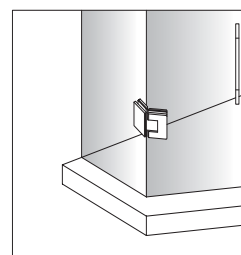
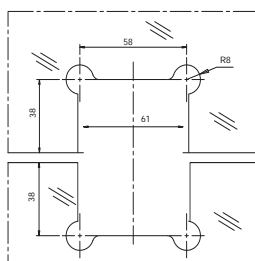
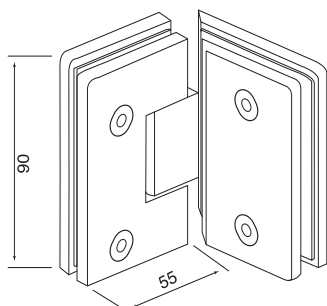

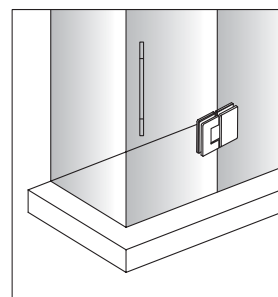
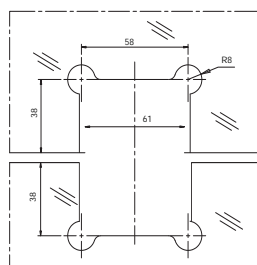
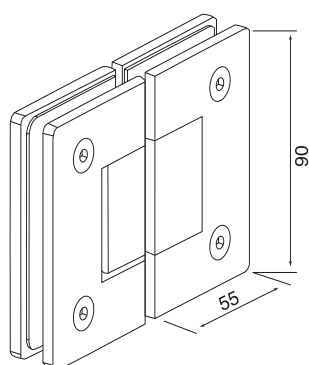

### HL63 - Glass to Glass Hinge 180 Degrees

Product code **HL63**

#### Features

- Developed for firm connecting of glass door with fixed glass at 180 degrees
- Made of SS 304 which makes the fittings highly corrosion resistant
- Gaskets provided to accommodate glass from 8-12 mm thickness and avoid glass damage
- Suitable for door weight up to 50 kg
- The door will shut automatically when closed till 25 degrees

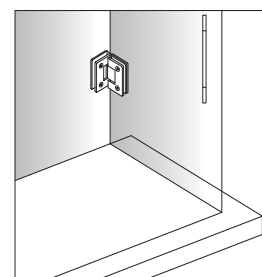
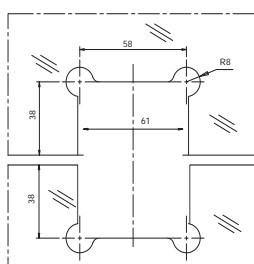
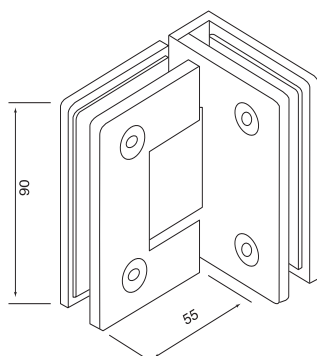

### HL64 - Glass to Glass Hinge 90 Degrees

Product code **HL64**

#### Features

- Developed for firm connecting of glass door with fixed glass at 90 degrees
- Made of SS 304 which makes the fittings highly corrosion resistant
- Gaskets provided to accommodate glass from 8-12 mm thickness and avoid glass damage
- Suitable for door weight up to 50 kg
- The door will shut automatically when closed till 25 degrees



### HL80 - Wall to Glass Clip

Product code **HL80**

#### Features

- Shower Clip for firm holding of glass with wall or floor
- Made of SS 304 which makes the fittings highly corrosion resistant
- Gaskets provided to accommodate glass from 8-12 mm thickness and avoid glass damage

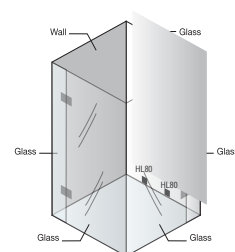
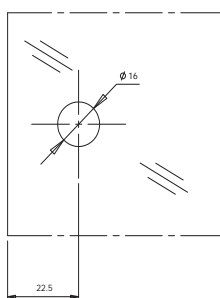
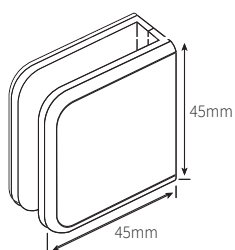

### HL81 - Wall to Glass Clip

Product code **HL81**

#### Features

- Shower Clip for firm holding of glass with wall or floor
- Made of SS 304 which makes the fittings highly corrosion resistant
- Gaskets provided to accommodate glass from 8-10 mm thickness and avoid glass damage

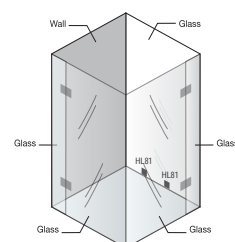
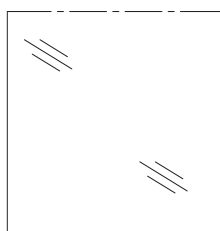
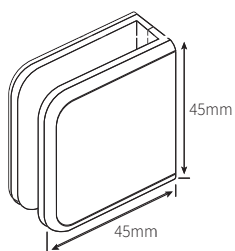



### HL82 - Wall to Glass Clip 90 Degrees

Product code **HL82**

#### Features

- Shower Clip for firm holding of glass with wall
- Made of SS 304 which makes the fittings highly corrosion resistant
- Gaskets provided to accommodate glass from 8-12 mm thickness and avoid glass damage

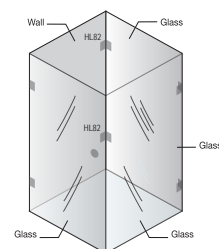
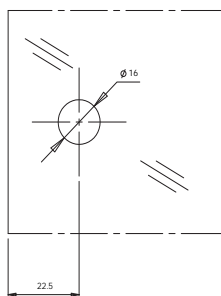
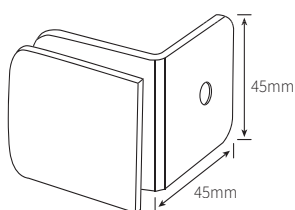

### HL83 - Glass to Glass Clip 90 Degrees

Product code **HL83**

#### Features

- Shower Clip for firm holding of fixed glass at 90 degrees
- Made of SS 304 which makes the fittings highly corrosion resistant
- Gaskets provided to accommodate glass from 8-12 mm thickness and avoid glass damage

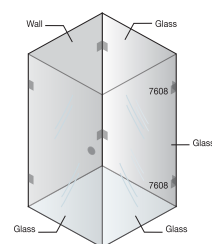
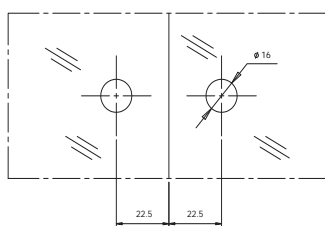
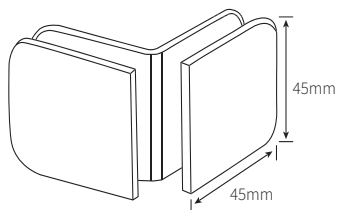





### HL84 - Glass to Glass Clip 135 Degrees

Product code **HL84**

#### Features

- Shower Clip for firm holding of fixed glass at 135 degrees
- Made of SS 304 which makes the fittings highly corrosion resistant
- Gaskets provided to accommodate glass from 8-12 mm thickness and avoid glass damage

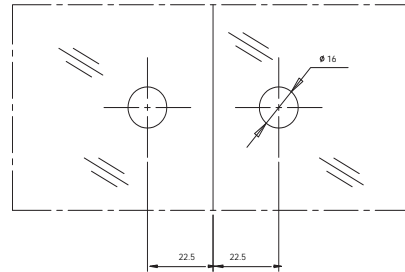
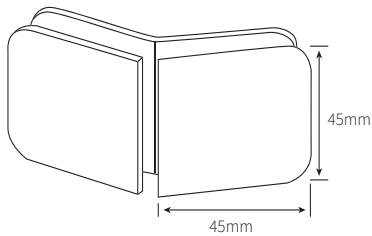

### HL85 - Glass to Glass Clip 180 Degrees

Product code **HL85**

#### Features

- Shower Clip for firm holding of fixed glass at 180 degrees
- Made of SS 304 which makes the fittings highly corrosion resistant
- Gaskets provided to accommodate glass from 8-12 mm thickness and avoid glass damage

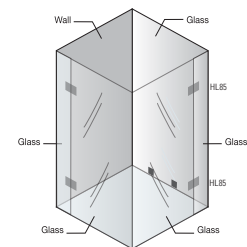
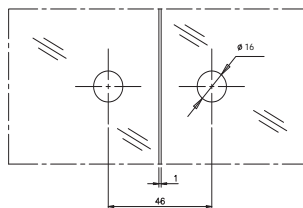
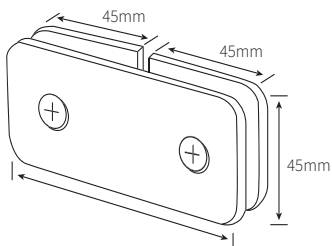



### HL301 - Shower Header Clip - Wall to Bar

Product code **HL301**

#### Features

- Shower Header Clip to hold pipe with the wall
- Made of SS304 which makes the fittings highly corrosion resistant and durable
- High load bearing capacity
- Suitable for Ø25 mm pipe

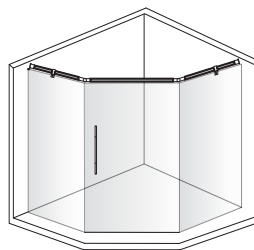
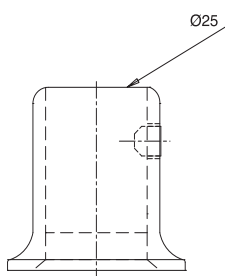

### HL303 - Shower Header Centre Clip

Product code **HL303**

#### Features

- Shower Header Clip to hold reinforcing pipe with the glass
- Made of SS304 which makes the fittings highly corrosion resistant and durable
- High load bearing capacity
- Suitable for Ø25 mm pipe

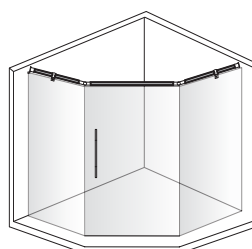
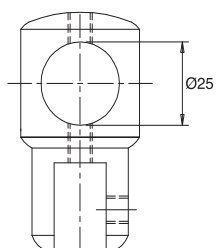



### HL305 - Two Shower Bar Connector

Product code **HL305**

#### Features

- Shower Header Clip to hold shower bar at any angle between 75 degrees and 285 degrees
- Made of SS304 which makes the fittings highly corrosion resistant and durable
- High load bearing capacity
- Suitable for Ø25 mm pipe

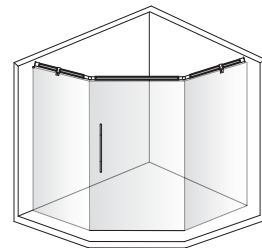
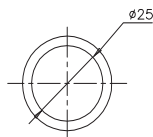
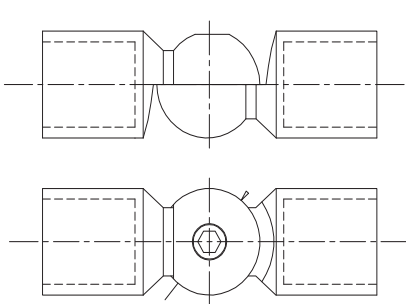

### HL306 - Three Shower Bar Connector

Product code **HL306**

#### Features

- Shower Header Clip to hold three pipes together
- Made of SS304 which makes the fittings highly corrosion resistant and durable
- High load bearing capacity
- Suitable for Ø25 mm pipe

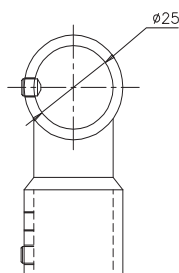
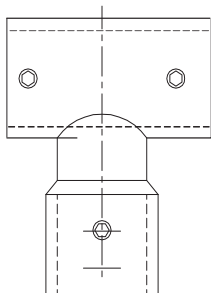



### HL343 - Magnetic Seals - 90/180 Degrees

Product code **HL343**

#### Features

- Made of PVC for durability
- Twin magnetic strips for firm closing



### HL344 - Magnetic Seals - 135 Degrees

Product code **HL344**

#### Features

- Made of PVC for durability
- Twin magnetic strips for firm closing

### HL331 - Weather Seals



### HL332 - Weather Seals

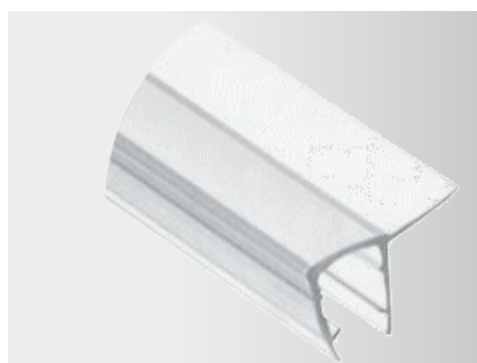

HL333 - Weather Seals

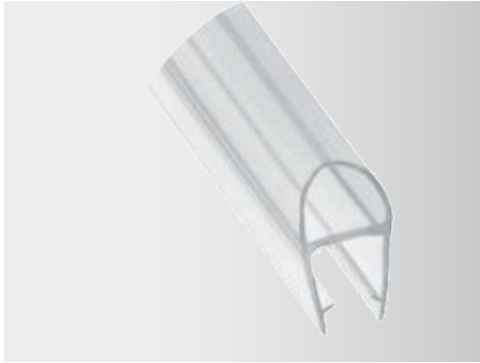

HL334 - Weather Seals



HL335 - Weather Seals

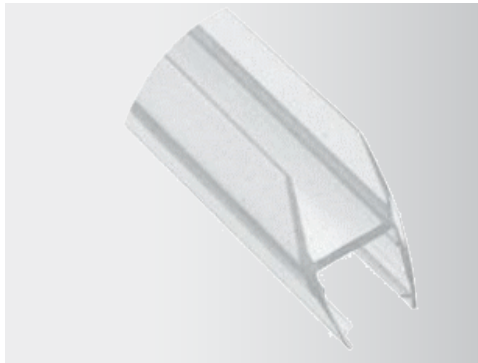



- ● Sliding System



## SL2000 - Glass Sliding Door System

Product code **SL2000**

### Features

- SS 304 glass holding point for high corrosion resistance
- Suitable for 8 mm to 10 mm glass
- Max door weight 50 kg



## SL2010 - Sliding Door System

Product code **SL2010**

### Features

- SS 304 glass holding point for high corrosion resistance
- Max door weight 80 kg







- • Spider Fittings



### 200B2 - 2 Way Spider

#### Features

- SS 304 material which makes fitting highly corrosion resistant

Product code	Finish
200B2	Satin, Polish

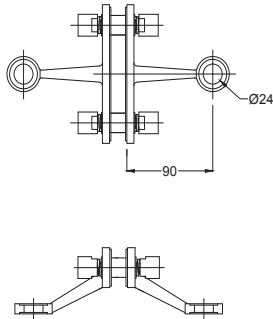

### 200B4 - 4 Way Spider

#### Features

- SS 304 material which makes fitting highly corrosion resistant

Product code	Finish
200B4	Satin, Polish

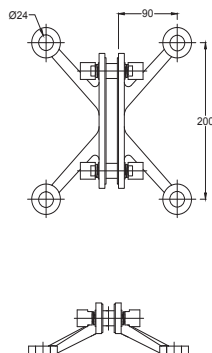



### 4 Way Spider

#### Features

- SS 304 material which makes fitting corrosion resistant

Product code	A (mm)	Finish
200A4	200	Satin, Polish
250A4	250	Satin, Polish

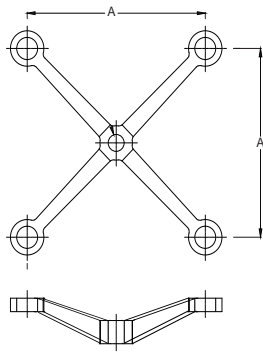

### 2 Way Spider 90 Deg

#### Features

- SS 304 material which makes fitting highly corrosion resistant

Product code	A (mm)	Finish
200A2A	200	Satin, Polish
250A2A	250	Satin, Polish

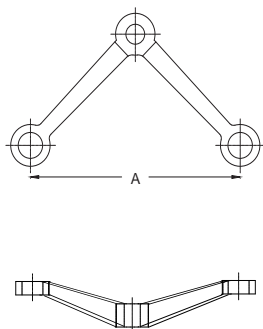



### 2 Way Spider 180 Deg

#### Features

- SS 304 material which makes fitting highly corrosion resistant

Product code	A (mm)	Finish
200A2B	200	Satin, Polish
250A2B	250	Satin, Polish

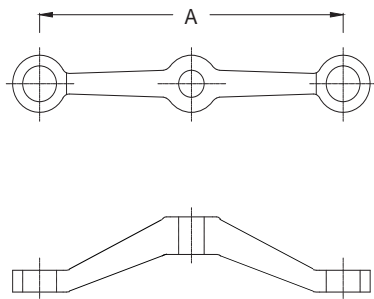

### 1 Way Spider

#### Features

- SS 304 material which makes fitting highly corrosion resistant

Product code	A (mm)	Finish
200A1	200	Satin, Polish
250A1	250	Satin, Polish

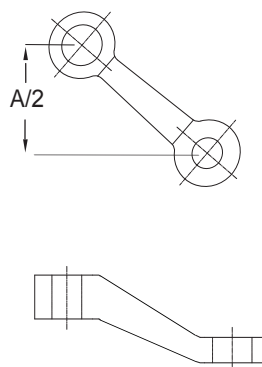



### 3 Way Spider

#### Features

- SS 304 material which makes fitting corrosion resistant

Product code	A (mm)	Finish
200A3	200	Satin, Polish
250A3	250	Satin, Polish

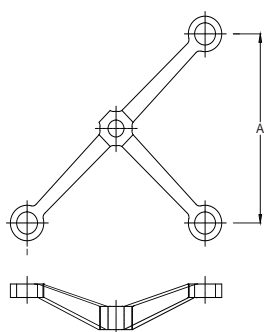

### CT09 - Connector

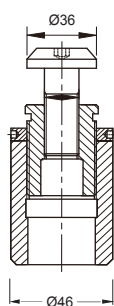

### RT09 - Routel

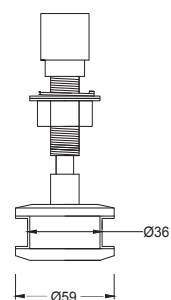



- • Door Closers

**HL31 - Door Closer**Product code **HL31**Maximum door weight **65 kg**Maximum door width **1050 mm****Features**

- Adjustable closing and latching speed
- Can be mounted in left/right, inside/outside

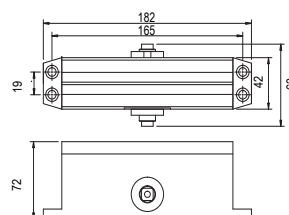
**HL32 - Door Closer**Product code **HL32**Maximum door weight **85 kg**Maximum door width **1200 mm****Features**

- Adjustable closing and latching speed
- Can be mounted in left/right, inside/outside

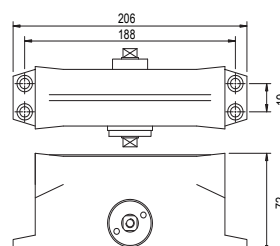



# HECKLER® | GLASS HARDWARE SOLUTIONS

## HECKLER HARDWARE

Vietnam Office : OV17.22, Viglacera Urban Area, Nam Tu Liem district, Hanoi city  
R&D HECKLER : Europa-Allee 165, 60486 Frankfurt am Main, Germany  
Hongkong Office : Room 01, 21/F, Prosper Commercial building, 9 Yin Chong street, Kowloon, HK  
Tel : (+84) 833 444 868  
Email : [hecklervietnam@gmail.com](mailto:hecklervietnam@gmail.com)  
Website : [heckler.com.vn](http://heckler.com.vn)

Disclaimer: The information and visuals of the products shown here are subject to change and Heckler reserves the right to make such amendments without notice.